



Παγκόσμιος Ηγέτης στο **Ιδανικό** Κλίμα.

Καθαριστές Αέρα



Κεντρικά Γραφεία | Ελ. Βενιζέλου 5
Έκθεση | Αριστείδου 40 & Ελ.Βενιζέλου 3
TK | 55133 | Καλαμαριά | Θεσσαλονίκη
T | 2310.440.844 F | 2310.432.868
e-mail: info@klimamichaniki.gr
www.klimamichaniki.gr





High-grade type with humidification

NEW Twin streamer unit

High speed electrons are discharged

NO NEED TO CHANGE



Pre-filter
Catches dust

NO NEED TO CHANGE

*regular cleaning is necessary

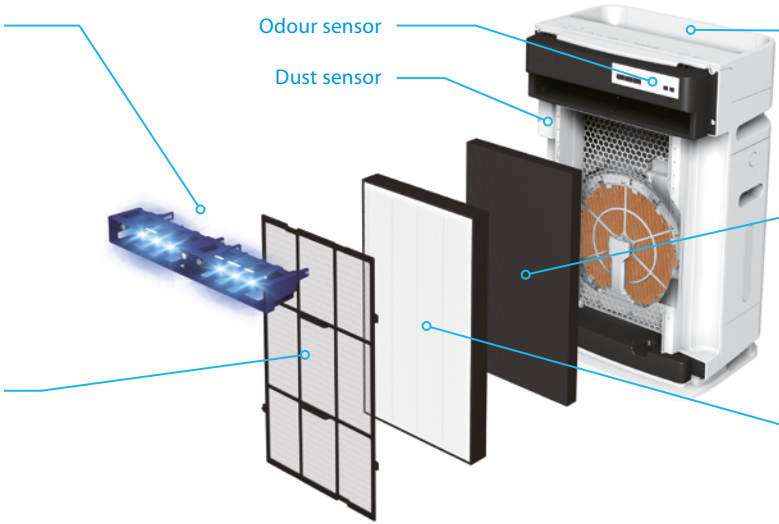

Odour sensor

Dust sensor

Active plasma ion generation unit

Plasma ions are discharged

NO MAINTENANCE OR EXCHANGE NEEDED

Deodorising filter
Absorbs odour

NO NEED TO CHANGE

HEPA filter

Catches fine particles of dust and pollen

NO NEED TO CHANGE FOR 10 YEARS

MCK70YV/YB

- Air purification for large spaces such as residential and light commercial applications
- Pure air thanks to Daikin 'Catch and Clean' approach in decomposing harmful substances
- High performance HEPA filter with no need to change for 10 years
- Whisper quiet

*Area calculated according to NRCC-54013-2011 standard using CADR value by test method based on Japan Electric Manufacturers' Association Standard JEM 1467.
 **Humidifying capacity by JEM1426 (electric humidifier) with turbo operation at temperature of 20°C and humidity of 30%.

MCK70YV/YB

HUMIDIFICATION	DUST COLLECTION	DEODORISATION
----------------	-----------------	---------------

Capacity in turbo operation mode

AIR PURIFICATION	HUMIDIFYING CAPACITY
Humidification + Air purification	650 ml/h
Airflow 7.0 m ³ /min. 420 m ³ /hour	
Applicable room area ~96 m ²	

Twin Streamer

Twice the decomposition power for dust particles & odours

Equipped with twice the Streamer units compared to conventional models, it also features a structural design that irradiates the filter even more effectively.

Decomposition of harmful gases is twice as fast¹

(In comparison with conventional Daikin products)

Equipped with twice the Streamer units compared to a previous model, it decomposes harmful gases such as exhaust gas at twice the speed.

This is an effect in a test space and not a test result in an actual operation space.

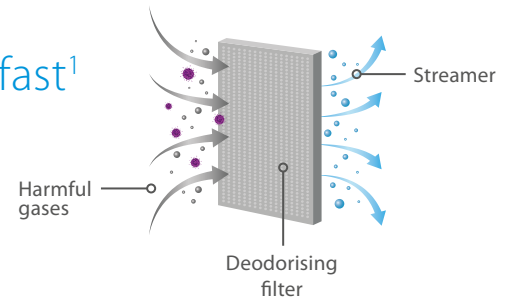

Deodorisation is twice as much²

(In comparison with previous Daikin product)

The deodorising filter absorbs odours, and twin streamer quickly decomposes them. Combining the effect of the deodorising filter doubles the amount of deodorisation.

The effect was in a test space of 29.4 m³ after 30 minutes of operation and was not a test result in an actual operation space.

Twin streamer even cleans the inside of the unit

- Removes bacteria on the dust collection filter.³
 - Speed of bacteria removal is as fast.⁴
- (In comparison with a previous Daikin model)

The effect was in a closed test space of approximately 25 m³ after 2.5 hours of operation and was not a test result in an actual operation space.

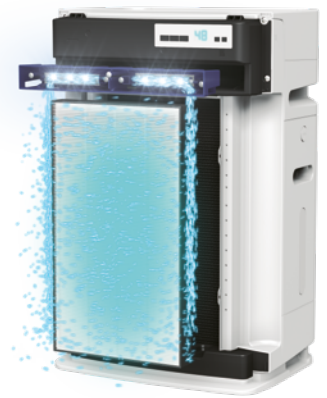

¹ Placed an air purifier in a 1m³ box with acetaldehyde as an exhaust gas-derived VOC and operated the air purifier (at maximum Streamer output operation). Measured the change in acetaldehyde concentration. (Only the decomposed amount was calculated by subtracting the amount of filter absorption.) (Daikin evaluation) Reduction of acetaldehyde concentration was confirmed to be twice as fast as conventional products. Comparison between 2018 MCK70U (Japanese model), a model equivalent to MCK70V and 2017 MCK70T (Japanese model). | ² Measured the change in ammonia concentration due to tobacco in a test space of 29.4 m³, and compared decrease from a concentration equivalent to Level 3 on the odour intensity scale. (Daikin evaluation) Test result: Confirmed that indoor ammonia concentration decreased by half after 30 minutes. Comparison between 2018 MCK70U (Japanese model), a model equivalent to MCK70V and 2017 MCK70T (Japanese model). | ³ Testing organization: Japan Food Research Laboratories. Test number: 17117469001-0101. Test method: Attached a test piece inoculated with bacterial liquid on the upstream side of the dust collection filter installed into the air purifier, and operated in a closed test space of 25m³. Counted the number of live bacteria after 2.5 hours. Test object: One bacterium type. Test result: Reduced by more than 99% after 2.5 hours. Test unit: Tested with MCK70U (Japanese model), a model equivalent to MCK70V. | ⁴ Twin streamer: reduced by more than 99% in 2.5 hours; Streamer: reduced by more than 99% in 5 hours.

Specifications

More details and final information can be found by scanning or clicking the QR codes.



MCK70YV



MCK70YB

Indoor Unit				MCK70YV	MCK70YB
Application				Floor standing type	
Applicable room area				48 (1) / 96 (2)	
Dimensions				600 x 395 x 287 (3)	
Weight				12.5	
Casing				White (N9.0)	
Fan				Multi Blade Fan (Sirocco fan with shroud assembly)	
Air flow rate				60/132/210/420	
Humidifying operation				102/132/210/420	
Sound pressure level				18/27/37/54	
Humidifying operation				23/27/37/54	
Power input				0.011/0.012/0.018/0.068	
Humidification				650	
Water tank capacity				3.6	
Power input				0.008/0.010/0.016/0.066	
Deodorizing method				Flash streamer + Deodorizing catalyst	
Dust collecting method				Electrostatic HEPA filter	
Air filter				Polyethylene terephthalate net	
Sign				01	
Dust sensor lamp: 3 stages / PM 2.5 sensor lamp: 3 stages / Odour sensor lamp: 3 stages / Humidity monitor: 20% - 90% / Humidity setting: Low/Standard/High / Airflow rate: Quiet/Low/Standard/Turbo / AUTO FAN mode / Econo mode / Anti-pollen mode / MOIST mode / CIRCULATION mode / Water supply lamp / Streamer lamp / Recommendation mode lamp / Humidifier ON/OFF lamp / Sleep mode / Child proof lock lamp					
Power supply				1~/50/60/220-240/220-230	
Type				Humidifying air purifier	

The applicable room area is appropriate for operating the unit of maximum fan speed (HH). Applicable room area indicates the space where a certain amount of dust particles can be removed in 30 minutes. ((1) in accordance with JEM (2) in accordance with CADR (JEM) & NRCC-54013-2011 standard) (3) With caster: 637 x 395 x 287 | Humidification amount changes in accordance with indoor and outdoor temperature and humidity. Measurement condition: 20°C in temperature, 30% in humidity. | Operating sound levels are the average of values measured at 1m away from the front, left, right and top of the unit. (These are equal to the values in an anechoic chamber) | Electrostatic HEPA filter and humidifying filters are attached in the unit.